

## How to String Your Guitar

When restringing your Freshman guitar, be sure to use care as the finish on the headstock will mark if the end of the string touches it. Detune and pull out the bridge pin from the bridge, before removing one string at a time, starting with the low E (thickest string).

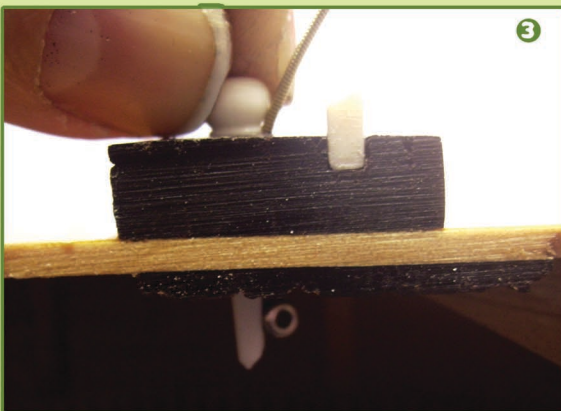

Unwind the string carefully from the machine head (tuner) post and place old string to one side. Remove new string of correct gauge from packet and insert ball end into bridge pin hole in the bridge. Make sure the ball end goes below the level of the underside of the guitar top. Replace the bridge pin firmly using finger pressure only (never hammer home a bridge pin) making sure the slot on the side of the pin is facing the neck of the guitar and the string runs in the slot. Pull the string up through the pin hole until it locks in position against the pin and the underside of the guitar top -->



### LUTHIER TIP!

Replacing one string at a time keeps the neck under the correct tension and your guitar should not require a settling in period after the change of strings.



## How to String Your Guitar

Pull string to the appropriate tuning post and feed it through the hole in the post. Leave enough slack in the string to allow 3-4 windings around the post. The first winding is always done by hand over the TOP of the string as it emerges through the hole in the post



This is a half-wind to enable subsequent windings, using the tuner button, to feed onto the post BELOW the string. Cut excess string length using small end nippers or pliers. Tune string to pitch.

